

NOTE:
THIS IS NOT A SURVEY. MAP FEATURES SHOWN ARE APPROXIMATE. PARCEL DATA SHOWN IS FROM THE KING COUNTY GIS PORTAL

BLACK CANYON HYDROELECTRIC
FERC PROJECT NO. P-14110
EXHIBIT G-1
PROJECT BOUNDARY AND
TRANSMISSION LINE
SCALE: 1" = 2000' KING COUNTY, WASHINGTON

DATE & TIME:
November 20, 2015 14:40
PLOTTED BY:
ADMIN

FILE NAME & LOCATION:
\\NSCS01B95\hok\PROJECT\HYDRO\Black Canyon\DWG\CONCEPT DESIGN SITE MAP-OVERALL.dwg

DATE & TIME
November 20, 2015 14:41
PLOTTER BY:
ADMIN

FILE NAME & LOCATION
\\NMS02199\hok\PROJECT\HYDRO\Black Canyon\DWG\CONCEPT DESIGN SITE MAP-OVERALL.dwg

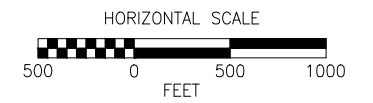
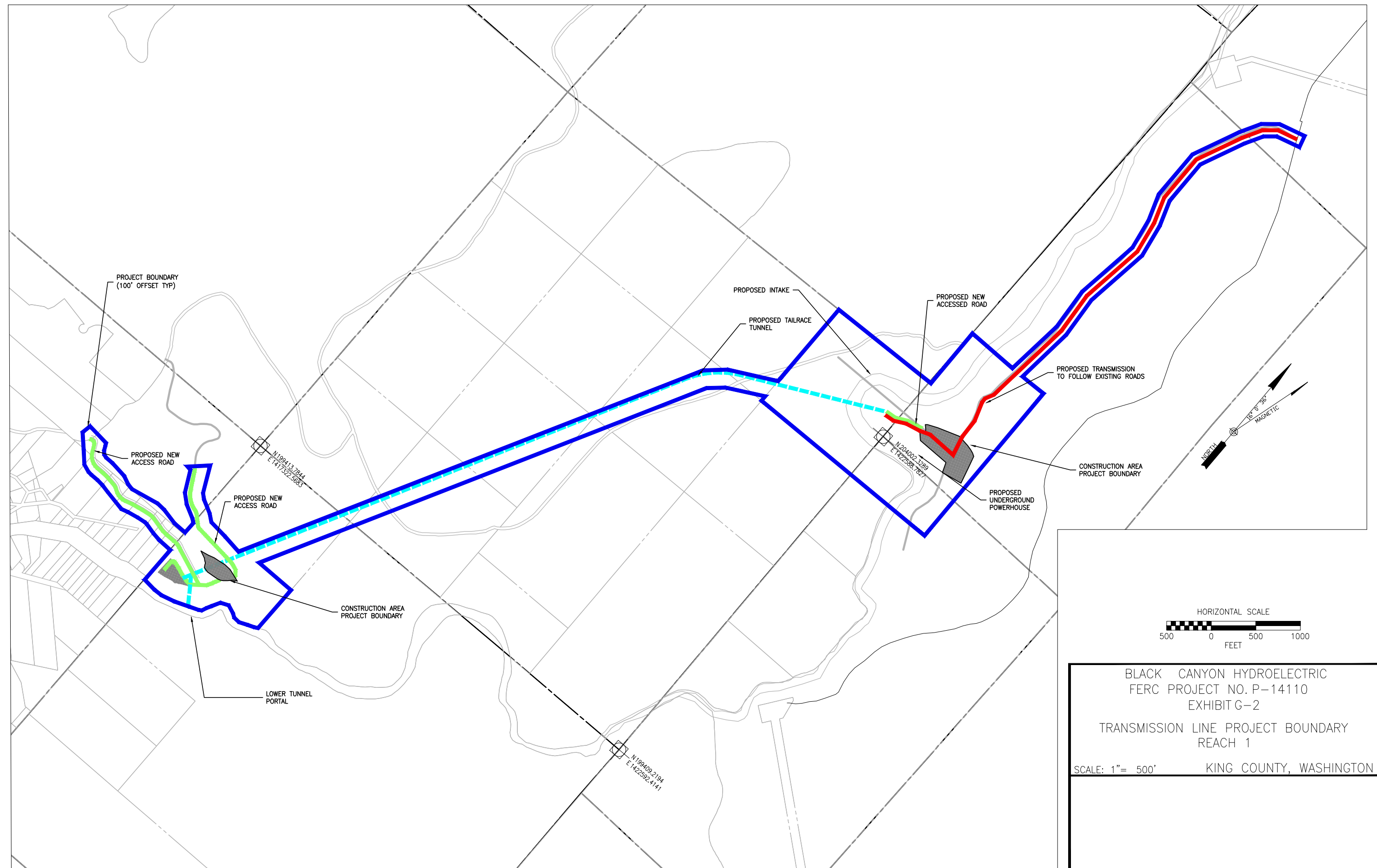

BLACK CANYON HYDROELECTRIC
FERC PROJECT NO. P-14110
EXHIBIT G-2
TRANSMISSION LINE PROJECT BOUNDARY
REACH 1
SCALE: 1" = 500' KING COUNTY, WASHINGTON